

Hercules Space Saver Sole Press series



HERCULESSD

Also available in single, SKU: HERCULESSS

Operator Manual

Manufactured by:



800 rue Rossiter, Saint-Jean-sur-Richelieu (QC) Canada J3B 8J1
www.landisinternational.ca info@landisinternational.ca
T.(450)359-8800 TF. 1-800-634-0806 F. (450) 359-9619

HERCULES SPACE SAVER PRESS

GENERAL DESCRIPTION

Your Hercules Press is designed to bring to your shop speed and efficiency.

The Hercules Press features eight pairs of lasts, two heel lasts, one soft sole pressure pad and one hard heel pressure pad for operations, easy to use controls and very simple maintenance.

Cementing requires normal preparations, but pay attention to a good pre-drying to secure a solid bind during the short cementing time. The delay for the pressing process depends upon the character of the cement used and for that reason the manufacturer's instructions for the use of the cement in question should be carefully observed.

INSTALLATION PROCEDURES

The Hercules Press should be positioned and levelled on a flat surface like a work bench. There is no electric cord required to operate this machine.

Connect the male quick disconnect air coupling of the Hercules Space Saver Press to your compressor. The **minimum air pressure required** from your compressor is **100 PSI or 650 Kpa**.

For a longer standstill and mainly **for the night your compressor must be stopped to prevent his automatic working device from running**. Drain water each day from the tank.

SAFETY INSTRUCTIONS

INSTRUCTIONS SHOULD BE READ BEFORE OPERATING EQUIPMENT

1. Ensure that the machine is operated just in a safe and functional way.
2. Before working on pneumatic parts for check up or repair, disconnect the Hercules Press from the air line.
3. Keep work area clean. Cluttered areas and benches invite accidents. Keep work area well lighted. Keep children away. All visitors should be kept at a safe distance from work area. Do not force equipment. It will do the job better and safer at the rate for which it was designed.
4. Wear proper apparel. Do not wear loose clothing, gloves, neckties, rings, bracelets or other jewelry to get caught in moving parts. Always use safety glasses. Everyday eyeglasses only have impact resistant lenses, they are NOT safety glasses.

OPERATIONAL INSTRUCTIONS

1. Choose the proper last size to fit the shoe or the boot you want to press.
2. Place last on the post.
3. Lock the last in place with the thumb screw.
4. Place shoe on the last.
5. Choose the proper cushion:

- The long one for soles (A)
- The rigid square one for heels (B)



6. Turn the pressure regulator.



to the desired pressure on gauge.



Normal operating pressure is 140 to 425 Kpa (20 to 60 PSI).

- Pressure may be changed up or down when the lasted shoe is either up or down.

7. To actuate the lasted shoe on the pressure pad, push the toggle valve down. You can play down or up the toggle valve to put more or less pressure on the shoe. Look how deep the lasted shoe is penetrating in the pressure pad when you are cementing a sole.

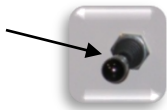

CAUTION: With the new “Super Glue” for synthetic materials, you can break the bonds between the sole and the shoe if you apply an extreme pressure.

8. Wait the desire time and pull up the toggle valve to finish the cementing operation. The lasted shoe will go up.

WARNING: At anytime you can cancel the cementing process by pulling up the toggle valve.

MAINTENANCE

A properly maintained machine will give you years of satisfactory service, whereas an abused machine will not. We strongly recommend that you observe the following procedures for your own benefit and safety.

WEEKLY MAINTENANCE

Each week, unplug the male quick disconnect air plug of the press, put inside this fitting 2 or 3 drops of pneumatic oil.



Once a week, the 25mm post that is going up and down should be lubricated with oil or molycote grease.



MAINTENANCE OF THE COMPRESSOR:

Check the oil level regularly. When it falls down to the minimum level, refer to the level mark on the dipstick, oil must be filled again. Use a good quality motor oil. An oil change once a year is highly recommended.

Drain condensation from the air tank at least once a week, daily is better, you will prevent to get water in the system.

TROUBLESHOOTING

TROUBLESHOOTING:

IF THE MACHINE DOES NOT OPERATE, FIRST check that:

1. There is sufficient air pressure coming to the cylinder. This can be checked by looking at the pressure gauge.



Or the main air hose of the press could be disconnected from the compressor, if so, plug it.



Or the compressor is not running (switch off), no air in the tank.

Or the pressure regulator on the compressor is set too low.

Or the pressure regulator on the Hercules might be set too low. Turn it to increase the pressure.

Or the flow control is totally close. To adjust it see next topic for speed.

IF THE SPEED AT WHICH THE SHOE IS PRESSED ON THE CUSHION IS TOO FAST:

2. Adjust the air flow control at the entry of the air cylinder. First take off the top cover.

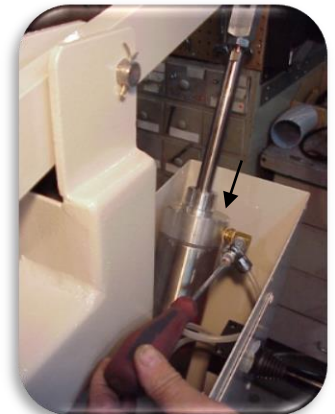

IF THE SPEED AT WHICH THE SHOE IS PRESSED ON THE CUSHION IS TOO SLOW:

3. Check the compressor, it could be on "OFF" position, not enough air in the tank.

Or look at the post for lasts if it jammed or if there are some marks on it.

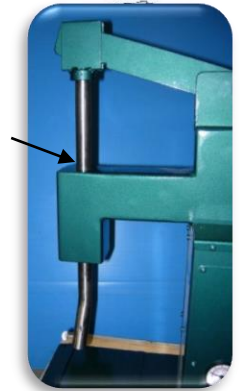

Or adjust the speed at which the rod is coming out of the cylinder by turning the screw on the air flow control. Not enough air is coming to the cylinder.

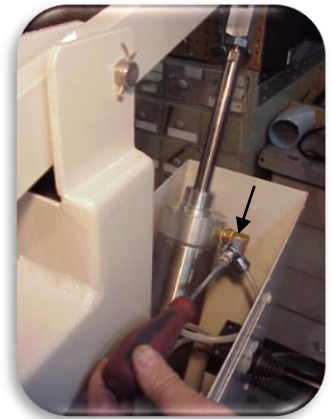

IF THE SHOE IS NOT PRESS ENOUGH ON THE PAD BECAUSE THERE IS A GAP BETWEEN THE SHOE AND THE PRESSURE PAD, YOU CAN ADJUST THE HEIGHT:

1. Take out the pin that is retaining the cylinder rod to the lever.



2. Unlock the nut that retained the rectangle block in place.



3. Unscrew the block that is screwed to the cylinder rod to adjust the height.



4. After you are set, lock the nut against the rectangle block.



5. Reinstall the pin in place.

IF YOU ARE UNABLE TO TURN THE KNOB OF THE PRESSURE REGULATOR:

1. Just pull the knob.



ACCESSIBILITY TO THE PNEUMATIC COMPONENTS:

CAUTION: Before removing the front panel unplug the air hose from the compressor.

1. Take off the front cover to reach the pneumatic components by taking off the screws.



2. **LABEL AND MARK** hoses before you unplug those.



3. To take out the pneumatic cylinder from the machine, first unscrew the metal housing.



HOW TO DISMANTLE THE RIGID PLASTIC TUBING FROM THE AIR FITTINGS INSIDE THE HOUSING:

Depress the outside ring of the air fitting and pull the tube out. After depressing the ring, the tubes can be removed without any damage.

To reinstall tubes, just push those in the air fittings. The connection is air tight again automatically.

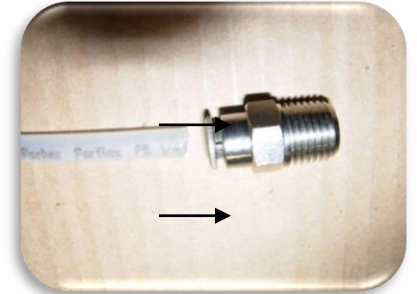

PARTS

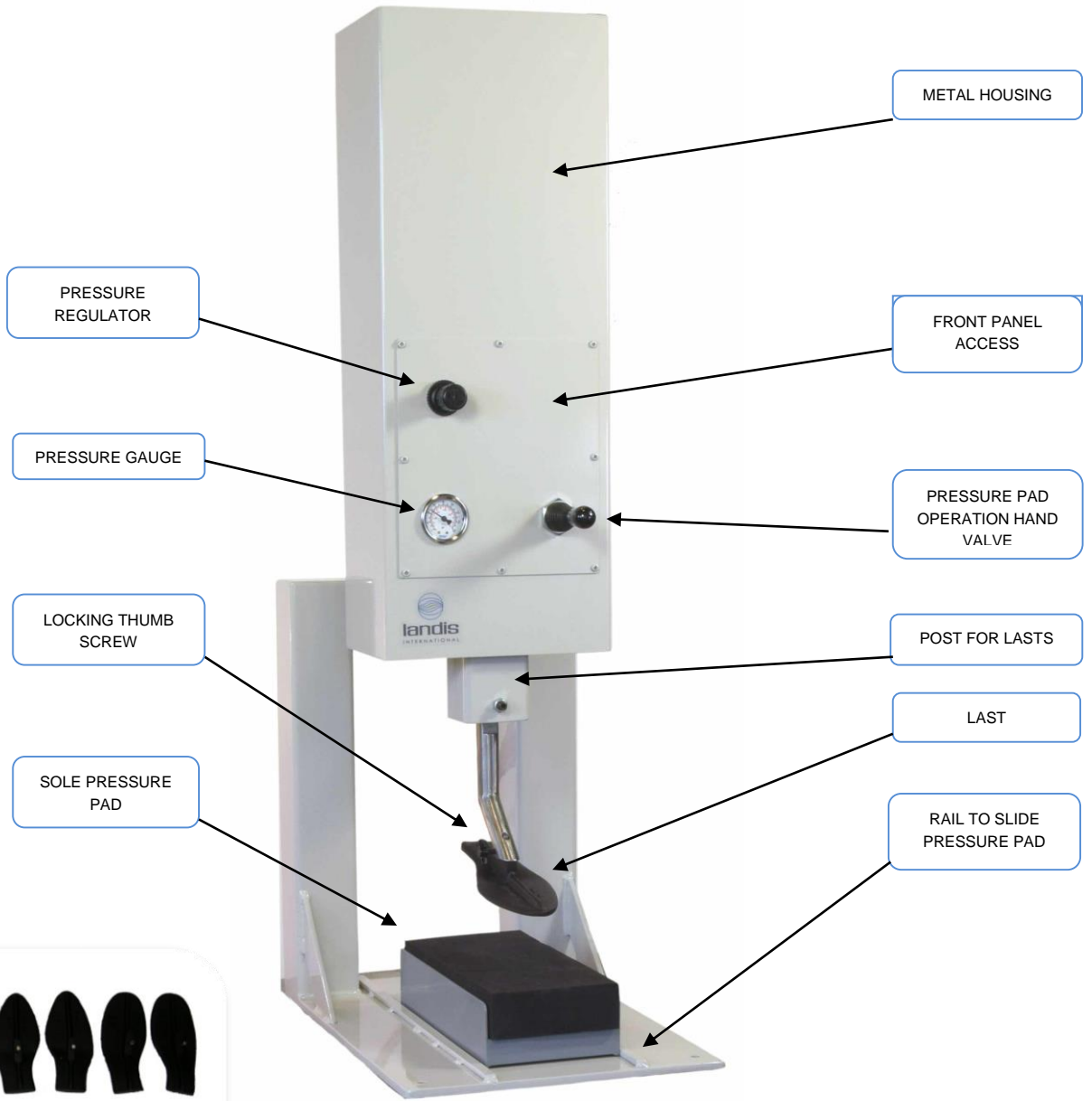

SOLE PRESSURE PAD

HEEL PRESSURE PAD

PARTS (FRONT VIEW)

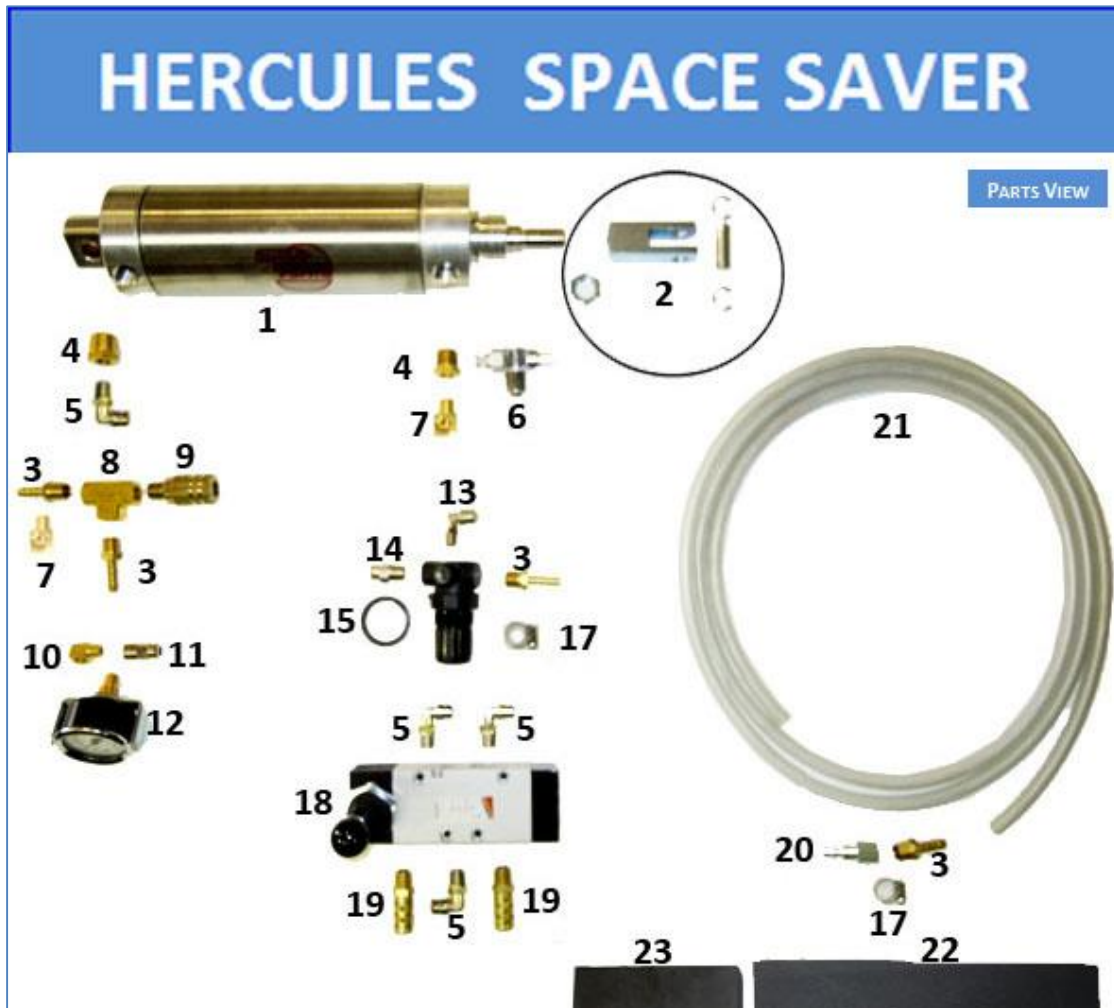

| # | Part Number | x | Description | # | Part Number | x | Description |
|----|-------------|------|----------------------------------|----|----------------|------|---------------------------|
| 1 | 706DXP | (1x) | Air cylinder | 13 | 65200402 | (2x) | Elbow male 1/8 |
| 2 | D13512A | (1x) | Air cylinder bracket | 14 | 65100404 | (2x) | Straight, male 1/8 |
| 3 | D1254B | (4x) | Hose barb 1/8" male | 15 | RRP95217 | (1x) | Regulator mounting nut |
| 4 | D110CB | (2x) | Reducer 3/8 x 1/8 NPT | 16 | R0002000 | (1x) | Air regulator |
| 5 | 65200404 | (1x) | Elbow male 1/8" | 17 | HS4 | (1x) | Hose collar |
| 6 | FQP44 | (1x) | Flow controller | 18 | HERCULESHV | (2x) | Toggle valve |
| 7 | D115B | (2x) | Elbow 90°, 1/8 male - 1/8 female | 19 | MUFFLER14 | (1x) | Muffer 1/8" |
| 8 | 101B | (1x) | T, 1/8 NPT female | 20 | S728 | (1x) | Coupler plug, female 1/8" |
| 9 | S716 | (1x) | Quick disconnect 1/8" female | 21 | H14R | (1x) | Hose 1/8" ID |
| 10 | D115A | (1x) | Elbow 90°, 1/8 male - 1/8 female | 22 | HERCULESCOU | (1x) | Sole cushion 6" x 12" |
| 11 | 64630402 | (2x) | Straight, female 1/8" | 23 | HERCULESPADHEE | (1x) | Heel cushion 6" x 6" |
| 12 | WI15220 | (2x) | Air gauge | | | | |